

I/A Series[®] Electronic Pressure Transmitters

—

IAP20-D, -F, -T Digital Absolute Pressure Transmitters

IGP20-D, -F, -T Digital Gauge Pressure Transmitters

and

IAP20-A and -V Analog Absolute Pressure Transmitters

IGP20-A and -V Analog Gauge Pressure Transmitters

—

Style A

Give instrument Model Code when ordering.

*Parts preceded by an asterisk are recommended spare parts.
See Recommended Spare Parts Summary section for quantities.

TO ORDER PARTS, CALL 1-866-746-6477.

MODEL CODE

Description	Model		
I/A Series, Electronic, Bracket-Mounted Absolute Pressure Transmitter	IAP20		
I/A Series, Electronic, Bracket-Mounted Gauge Pressure Transmitter	IGP20		
Electronics Versions and Output Signal			
Intelligent; Digital FoxCom™ and/or 4 to 20 mA dc, Configurable (Version -D)	-D		
Intelligent; Digital FOUNDATION Fieldbus - FISCO Compliant (Version -F)	-F		
Intelligent; Digital HART and 4 to 20 mA (Version -T)	-T		
Analog; 4 to 20 mA ac, Explosionproof (Version -A)	-A		
Analog; 1 to 5 V dc, Low Power (Version -V)	-V		
Structure Code - Select from one of the following four groups:			
1. Transmitter with Traditional Structure			
Covers	Sensor		
	Fill Fluid		
Steel	Co-Ni-Cr	Silicone	10
Steel	Co-Ni-Cr	Inert	11
Steel	316L ss	Silicone	12
Steel	316L ss	Inert	13
Steel	Nickel alloy (a)	Silicone	16
Steel	Nickel alloy (a)	Inert	17
316 ss	Co-Ni-Cr	Silicone	20
316 ss	Co-Ni-Cr	Inert	21
316 ss	316L ss	Silicone	22
316 ss	316L ss	Inert	23
316 ss	316L ss, Gold Plated	Silicone	2G
316ss	Monel	Silicone	24
316 ss	Monel	Inert	25
316 ss	Nickel alloy (a)	Silicone	26
316 ss	Nickel alloy (a)	Inert	27
Monel	Monel	Silicone	34
Monel	Monel	Inert	35
Nickel alloy (a)	Nickel alloy (a)	Silicone	46
Nickel alloy (a)	Nickel alloy (a)	Inert	47
Nickel alloy (a)	Tantalum	Silicone	48
Nickel alloy (a)	Tantalum	Inert	49
pvdf Insert (Kynar)	Tantalum	Silicone (Used w/Process Connector Type 7)	78 (b)
pvdf Insert (Kynar)	Tantalum	Inert (Used w/Process Connector Type 7)	79 (b)
2. Transmitter prepared for Model Coded Remote Mount Seals (c) (d)			
Transmitter prepared for Remote Seal HI Side; Silicone Fill in Sensor			S3
Transmitter prepared for Remote Seal HI Side; Inert Fill in Sensor (IGP20 only)			S4
3. Transmitter Prepared for Model Coded Direct Connect Seals (c)			
PSFLT, PSSCT, or PSSST Direct Connect Seal on HI Side; Silicone Fill (IGP20 only)			F1
PSFLT, PSSCT, or PSSST Direct Connect Seal on HI Side; Inert Fill (IGP20 only)			F2
4. Transmitter Prepared for Seals not from the Company			
Remote Seal on High Side and 1/2 NPT Connector on Low Side, Silicone Fill in Sensor			SC
Remote Seal on High Side and 1/2 NPT Connector on Low Side, Inert Fill in Sensor			SD
Span Limits (Absolute or Gauge Pressure Units)			
kPa	inH₂O	mbar	Available with:
0.12 and 7.5	0.5 and 30	1.2 and 75	IGP20 only
0.87 and 50	3.5 and 200	8.7 and 500	IAP20 and IGP20
			A (e) B

MODEL CODE

MODEL CODE (Continued)

Description	Model																				
<table border="0"> <tr> <td>MPa</td> <td>psi</td> <td>bar or kg/cm²</td> <td>Available with:</td> </tr> <tr> <td>0.007 and 0.21</td> <td>1 and 30</td> <td>0.07 and 2.1</td> <td>IAP and IGP20</td> </tr> <tr> <td>0.07 and 2.1</td> <td>10 and 300</td> <td>0.7 and 21</td> <td>IAP and IGP20</td> </tr> <tr> <td>0.7 and 21</td> <td>100 and 3000</td> <td>7 and 210</td> <td>IAP and IGP20</td> </tr> <tr> <td>1.38 and 35</td> <td>200 and 500</td> <td>13.8 and 350</td> <td>IGP20 only</td> </tr> </table>	MPa	psi	bar or kg/cm²	Available with:	0.007 and 0.21	1 and 30	0.07 and 2.1	IAP and IGP20	0.07 and 2.1	10 and 300	0.7 and 21	IAP and IGP20	0.7 and 21	100 and 3000	7 and 210	IAP and IGP20	1.38 and 35	200 and 500	13.8 and 350	IGP20 only	<p>C D E (f) F (f)</p>
MPa	psi	bar or kg/cm²	Available with:																		
0.007 and 0.21	1 and 30	0.07 and 2.1	IAP and IGP20																		
0.07 and 2.1	10 and 300	0.7 and 21	IAP and IGP20																		
0.7 and 21	100 and 3000	7 and 210	IAP and IGP20																		
1.38 and 35	200 and 500	13.8 and 350	IGP20 only																		
Process Connector Type (Material Same as Process Cover Material)																					
None; connect directly to process cover (not available with Structure Codes 78 and 79)	0																				
1/4 NPT (not available with Structure Codes 46, 47, 48, 49, 78, 79, or with seals)	1																				
1/2 NPT (not available with Structure Codes 78, 79, or with seals)	2																				
Rc 1/4 (not available with Structure Codes 46, 47, 48, 49, 78, 79, or with seals)	3																				
Rc 1/2 (not available with Structure Codes 78, 79, or with seals)	4																				
1/2 Schedule 80 Welding Neck (not available with Structure Codes 46, 47, 48, 49, 78, 79, or with seals)	6																				
None; pvdf (Kynar) insert tapped for 1/2 NPT on side of 316 ss Process Cover (used only with Codes 78/79)	7																				
Conduit Connection and Housing Material																					
1/2 NPT Connection, Both Sides, Aluminum Housing	1																				
PG 13.5 Connection, Both Sides, Aluminum Housing (with Electrical Safety Codes E, D, M, and N only)	2																				
1/2 NPT Connection, Both Sides, 316 ss Housing	3																				
PG 13.5 Connection, Both Sides, 316 ss Housing (with Electrical Safety Codes E, D, M, and N only)	4																				
M20 Connection, Both Sides, Aluminum Housing (with Electrical Safety Codes E, D, M, and N only)	5																				
M20 Connection, Both Sides, 316 ss Housing (with Electrical Safety Codes E, D, M, and N only)	6																				
Electrical Safety																					
INMETRO (see PSS 2A-1C13E for -F and PSS 2A-1C13B for -T)	1																				
INMETRO (see PSS 2A-1C13A for -D, PSS 2A-1C13E for -F, PSS 2A-1C13B for -T, PSS 2A-1C13C for -A, and PSS 2A-1C13D for -V)	2																				
EAC (see PSS 2A-1C13E for -F and PSS 2A-1C13B for -T)	4																				
EAC (see PSS 2A-1C13E for -F and PSS 2A-1C13B for -T)	5																				
EAC (see PSS 2A-1C13A for -D, PSS 2A-1C13E for -F, PSS 2A-1C13B for -T, PSS 2A-1C13C for -A, and PSS 2A-1C13D for -V)	6																				
ATEX (see PSS 2A-1C13A for -D, PSS 2A-1C13E for -F, and PSS 2A-1C13B for -T)	E																				
ATEX (see PSS 2A-1C13A for -D, PSS 2A-1C13E for -F, PSS 2A-1C13B for -T, PSS 2A-1C13C for -A, and PSS 2A-1C13D for -V) (g)	D																				
ATEX (see PSS 2A-1C13A for -D, PSS 2A-1C13E for -F, and PSS 2A-1C13B for -T)	N																				
ATEX Multiple Certifications (includes ATEX Codes E, D, and N) (see PSS 2A-1C13A for -D and PSS 2A-1C13B for -T) (g)	M																				
CSA (see PSS 2A-1C13A for -D, PSS 2A-1C13E for -F, PSS 2A-1C13B for -T, PSS 2A-1C13C for -A, and PSS 2A-1C13D for -V)	C																				
CSA (see PSS 2A-1C13A for -D, PSS 2A-1C13E for -F, PSS 2A-1C13B for -T, PSS 2A-1C13C for -A, and PSS 2A-1C13D for -V) (g)	B																				
FM Approvals (see PSS 2A-1C13A for -D, PSS 2A-1C13E for -F, PSS 2A-1C13B for -T, PSS 2A-1C13C for -A, and PSS 2A-1C13D for -V)	F																				
FM Approvals (see PSS 2A-1C13A for -D, PSS 2A-1C13E for -F, PSS 2A-1C13B for -T, PSS 2A-1C13C for -A, and PSS 2A-1C13D for -V) (g)	G																				
IECEX Certifications (see PSS 2A-1C13E for -F and PSS 2A-1C13B for -T)	T																				
IECEX Certifications (see PSS 2A-1C13E for -F and PSS 2A-1C13B for -T)	U																				
IECEX Certifications (see PSS 2A-1C13A for -D, PSS 2A-1C13E for -F, PSS 2A-1C13B for -T, PSS 2A-1C13C for -A, and PSS 2A-1C13D for -V)	V																				
Multi-marked for ATEX, CSA, and FM Intrinsically Safe Applications (see PSS 2A-1C13B for -T)	W																				

MODEL CODE (Continued)

Description	Model
Optional Selections	
Refer to Optional Selection descriptions below.	
Mounting Bracket Set - Not available with Direct Connect Seals, Codes F1 and F2	
Standard Style Painted Steel Bracket with Plated Steel Bolts	-M1
Standard Style Stainless Steel Bracket with Stainless Steel Bolts	-M2
Universal Style Stainless Steel Bracket with Stainless Steel Bolts	-M3
Digital Indicator with Pushbuttons or Solid (Blind) Cover over Standard Indicator	
Digital Indicator, Pushbuttons, and Window Cover (with Electronics Versions -D, -F, and -T only)	-L1
Substitute Solid (Blind) Cover over Standard Indicator (with Electronics Versions -A and -V only)	-L2
DIN 19213 Construction - Specify Process Conn. Code 0, and with 316 ss covers having no side vents (h)	
Single Ended Process Cover with M10, B7 Steel Bolting; derated to 16 MPa (2320 psi)	-D1
Double Ended Process Cover with M10, B7 Steel Bolting (Blind Kidney Flange on Back) (i) derated to 10 MPa (1500 psi)	-D2
Single Ended Process Cover with 7/16 in, B7 Steel Bolting; standard rating 25 MPa (3625 psi)	-D3
Double Ended Process Cover with 7/16 in, B7 Steel Bolting (Blind Kidney Flange on Back) (i) derated to 10 MPa (1500 psi)	-D4
Single Ended Process Cover with 7/16 in, 316 ss Bolting; derated to 15 MPa (2175 psi)	-D5
Double Ended Process Cover with 7/16 in, 316 ss Bolting (Blind Kidney Flange on Back) (i) derated to 10 MPa (1500 psi)	-D6
Single Ended Process Cover with 7/16 in, 17-4 ss Bolting; standard rating 25 MPa (3625 psi)	-D7
Double Ended Process Cover with 7/16 in, 17-4 ss Bolting (Blind Kidney Flange on Back) (i) derated to 10 MPa (1500 psi)	-D8
Cleaning and Preparation - Not Available w/Gold-Plated Sensor, Structure 2G, or Pressure Seals	
Unit Degreased - for Silicone Filled Sensors only (Not for Oxygen/Chlorine/Other Fluids that may react with Silicone)	-X1
Cleaned and Prepared for Oxygen Service - for Inert Filled Sensors only (Not available with Carbon Steel Covers or with Silicone Filled Sensors)	-X2
Cleaned and Prepared for Chlorine Service - for Inert Filled Sensors only (j) (Not available with Carbon Steel Covers or with Silicone Filled Sensors)	-X3
Bolting for Process Covers/Connectors (k)	
316 ss Bolts and Nuts (pressure derated)	-B1
17-4 ss Bolts and Nuts	-B2
B7M Bolts and Nuts (NACE) (pressure derated) (l)	-B3
Conduit Thread Adapters (Not available with Conduit Connection Codes 5 and 6)	
Hawke-Type 1/2 NPT Cable Gland for use with Conduit Connection Codes 1 and 3 (m)	-A1
Plastic PG 13.5 Cable Gland for use with Conduit Connection Codes 2 and 4 (n)	-A2
M20 Connector for use with Conduit Connection Codes 1 and 3 (m)	-A3
Brass PG 13.5 Cable Gland (Trumpet-Shaped) for use with Conduit Connection Codes 2 and 4 (n)	-A4
Electronics Housing Features	
External Zero Adjustment (o)	-Z1
Custody Transfer Lock and Seal	-Z2
External Zero Adjustment and Custody Transfer Lock and Seal (o)	-Z3
Custom Factory Configuration	
Digital Output (4 to 20 mA Default if not selected) - available with FoxCom Version D Only	-C1
Full Factory Configuration (Requires Configuration Form to be filled out)	-C2

MODEL CODE

MODEL CODE (Continued)

Description	Model
<u>Tubing Connectors - (Only 316 ss process covers; no side vents on cover)</u>	
Steel, Connecting 6 mm Tubing to 1/4 NPT Process Connector Available only with Structure Codes 10, 11, 12, and 13; and only with Process Connector Codes 0 and 1	-E1
Steel, Connecting 12 mm Tubing to 1/2 NPT Process Connector Available only with Structure Codes 10, 11, 12, and 13, and only with Process Connector Code 2	-E2
316 ss, Connecting 6 mm Tubing to 1/4 NPT Process Connector Available only with Structure Codes 10, 11, 12, 13, 20, 21, 22, 23, and 26; and only with Process Connector Codes 0 and 1.	-E3
316 ss, Connecting 12 mm Tubing to 1/2 NPT Process Connector Available only with Structure Codes 10, 11, 12, 13, 20, 21, 22, 23, and 26; and only with Process Connector Code 2	-E4
<u>Gaskets</u>	
Gasket for Vacuum Service with Seals (p)	-G1
<u>SIL2 Transmitters for HART Versions Only</u>	
SIL2-Certified HART Transmitters	-S2
<u>Instruction Books (Common MI, Brochure, and Full Documentation Set on CD-ROM is Standard)</u>	
Without Instruction Book and CD - Only "Getting Started" Brochure is supplied	-K1
<u>Miscellaneous Optional Selections</u>	
Low Temperature Operative Limit of Electronics Housing Extended Down to -50°C (-58°F) Not available with Electronics Version -V, or sensors and seals with Inert fill; or Structure Codes 78 and 79; or DIN Options -D2, -D4, -D6, and -D8	-J
Vent Screw in side of Process Cover (with 316 ss process covers only) Not with Structure Codes 78 and 79, and not with pressure seals	-V (q)
Supplemental Customer Tag (Stainless Steel Tag wired onto Transmitter)	-T
Examples: IGP20-D20B21F-M1Z2; IAP20-DS3C11F-T	

- a. Equivalent to Hastelloy® C. Hastelloy is a registered trademark of Haynes International, Inc.
- b. Maximum overrange pressure is 2.1 MPa (300 psi); temperature limits are -7 and +82°C (20 and 180°F).
- c. Transmitter and Pressure Seal Model Codes are both required. See PSS 2A-1Z11 A for the various pressure seal model codes.
- d. Remote Seal Models that may be specified are PSFPS, PSFES, PSFAR, PSTAR, PSISR, PSSCR, and PSSSR
- e. Span Limit Code A is not available with pressure seals.
- f. Span Limit Codes E and F are not available with Structure Codes 78 and 79 (pvdf insert in HI Side Cover)
- g. Cover lock provided as standard with Electrical Safety Codes D, B, G, and M.
- h. Not available when Remote Mount or Direct Connect Pressure Seals are specified.
- i. Mounting Set option is not available.
- j. When -X3 is specified, the standard bolting is replaced with 17-4 ss bolts and nuts. Therefore, there is no need to specify Option -B2 when selecting the Chlorine Service Option -X3.
- k. Not available with DIN construction options, and not available with Structure Codes 78 and 79. For stainless steel bolts with DIN construction, specify -D5 to -D8, as required.
- l. Selection of -B3 normally requires selection of AS References MR-01. Also, -B3 not available with Structure Code 2G.
- m. Available with Electrical Safety Codes D, E, M, and N only.
- n. Available with Electrical Safety Code E only.
- o. External Zero Adjustment cannot be used with Electronics Versions -A (Analog) and -V (Low Power).
- p. Standard offering with IAP20 Transmitters. However, -G1 is a required option with IGP20 Transmitters when pressure seal (Structure Codes S3, S4, F1, F2, SC, and SD) will be used in vacuum applications. This option substitutes vacuum service metal gasket for standard ptfе process cover gasket.
- q. Not available when Remote Mount of Direct Connect Pressure Seals are specified.

PARTS

Figure 1. TRANSMITTER ASSEMBLY – TOPWORKS

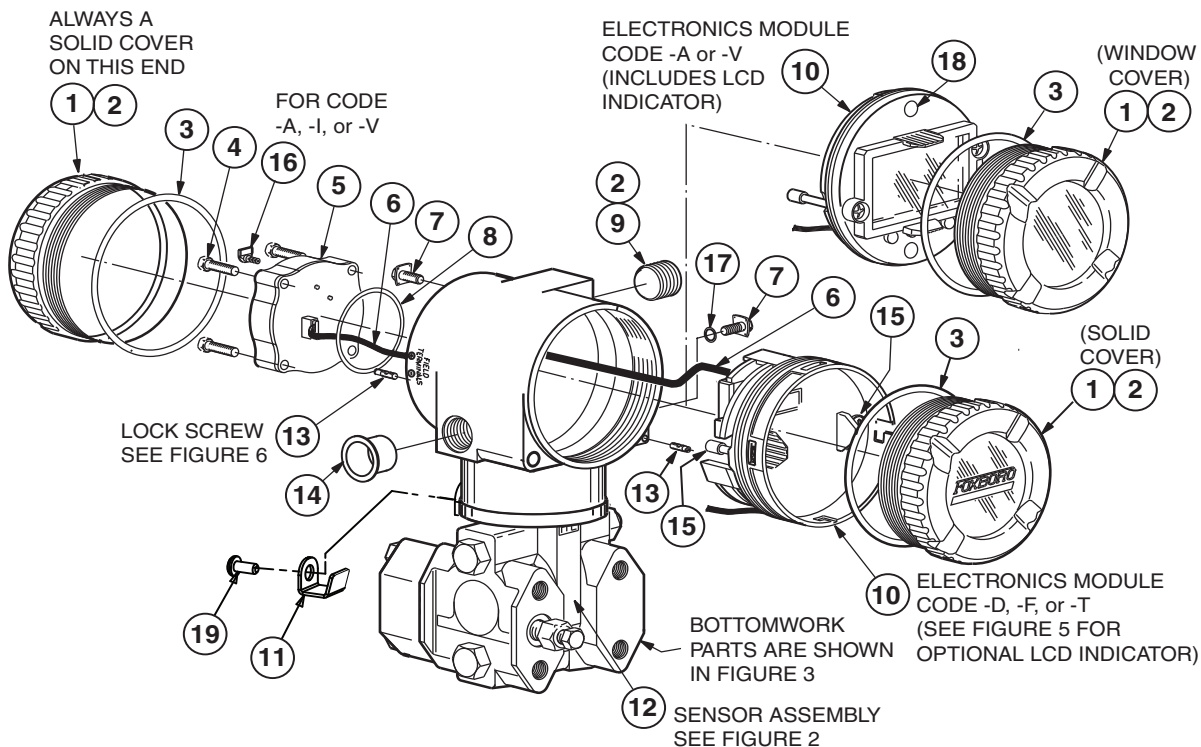

Item	Part No.	Qty.	Part Name
1	Below		Cover, Aluminum - with Versions -A or -V
	D0162AP	1	Solid Cover (Two Required with Option -L2)
	D0162LG	1	Window Cover (None Required with Option -L2)
1	Below		Cover, Stainless Steel - with Versions -A or -V
	D0162VD	1	Solid Cover (Two Required with Option -L2)
	D0162VG	1	Window Cover (None Required with Option -L2)
1	Below		Cover, Aluminum - with Versions -D, -F, or -T
	B0162AP	2	Solid Cover - See Figure 3 for -L1 LCD Indicator Option with a Window Cover
1	Below		Cover, Stainless Steel - with Versions -D, -F, or -T
	B0162VD	2	Solid Cover - See Figure 3 for -L1 LCD Indicator Option with a Window Cover
2	X0118CC	1	Grease, Lubriplate (1-3/4 ounce tube)
*3	X0201FC	2	O-Ring, Cover
4	Below	4	Screw, Terminal Block Assy, 0.138-32 x 0.750
	X0133UW		Steel Screw - used with Aluminum Housing
	X0133VP		316 ss Screw - used with 316 ss Housing

Item	Part No.	Qty.	Part Name
5	Below	1	Terminal Block Assembly
	D0149YB		Electronics Versions -A, -D, and -T
	D0149HN		Electronics Versions -F and -P
	D0149FE		Electronics Version -V
6	P0177JE	1	Cable, Power, Replaceable (Versions -F and -V only)
7	D0162VJ	4	Screw Assembly, Earth (Ground), 0.164-32 x 0.375
8	X0144KR	1	O-Ring
9	Below	1	Pipe Plug for Unused Conduit Connection – see WARNING
	B0139CA		Pipe Plug, Aluminum, 1/2 NPT; with Housing Code 1
	B0139SK		Pipe Plug, 316 ss, 1/2 NPT; with Housing Code 3
	X0178GT		Pipe Plug, 316 ss, PG 13.5; with Housing Codes 2 and 4
	D0179FJ		Pipe Plug, Aluminum, M20; with Housing Code 5
	D0179FK		Pipe Plug, 316 ss, M20; with Housing Code 6
*10	Below	1	Electronics Module
	D0162VR		Digital FoxCom and/or 4 to 20 mA (Version -D)
	D0162UU		Digital FOUNDATION Fieldbus - FISCO compliant (Version -F)
	D0162VZ		Digital HART and 4 to 20 mA (Version -T)
	D0162ZP		Analog 4 to 20 mA (Version -A)
	D0162ZX		Analog 1 to 5 V dc, Low Power (Version -V)
11	D0197PS	1	Clip, Retention
*12	Figure 2	1	Replacement Sensor Assembly - see NOTE and Figure 2
13	D0162WM	2	Screw, Lock, 0.164-32; part of Optional Selection -Z2; Refer to Figure 6.
14	S0102BT	1	Plug, Poly (Remove prior to Transmitter Installation)
15	Below	2	Screw, Captive, Pan Head, 0.138-32 x 0.615
16	D0162WS	1	HHT Plug, Analog (Version -A or -V)
17	X0173YA	1	Washer, Ext. Ground, 0.196 ID, 0.383 OD
18	X0201FW	2	Button
19	X0174EX	1	Screw, Button Hd; 0.164-32 x 0.25 long

⚠ WARNING

To maintain IP66 (IEC 529) and NEMA 4X protection, the unused conduit opening must be closed with a metal plug. In addition, the threaded housing covers must be properly installed

— NOTE

The sensor assembly configuration varies with fill fluid, wetted part material, and maximum span. Refer to Figure 2 for part numbers of these various configurations.

Figure 2. REPLACEMENT SENSOR ASSEMBLY
(Item 12 of Figure 1)

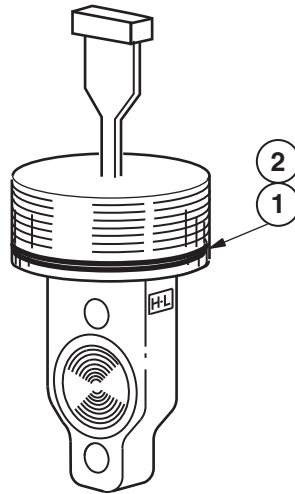

Item	Part No.	Qty.	Part Name
*1	Below	1	O-Ring, Housing Neck
	X0201LY		O-Ring, Standard
	X0144KW		O-Ring for use with CSA Certifications only; see WARNING
2	X0118CC	A/R	Lubricant

WARNING

Failure to install the proper Housing Neck O-Ring (Item 1) for CSA-labeled products violates ANSI/ISA 12.27.01

Cobalt-Nickel-Chromium Sensor, Silicone Oil Fill Fluid

Part No. (IGP20)	Reference Model Code (IGP20)	Maximum Span	Reference Model Code (IAP20)	Part No. (IAP20)
D0175DM	IGP20-..0A	7.5 kPa (30 inH ₂ O)	N/A	N/A
D0170GF	IGP20-..0B	50 kPa (200 inH ₂ O)	IAP20-..0B	D0175UA
D0170GL	IGP20-..0C	210 kPa (840 inH ₂ O)	IAP20-..0C	D0175UD
D0170GR	IGP20-..0D	2.1 MPa (300 psi)	IAP20-..0D	D0175UG
D0170GW	IGP20-..0E	21 MPa (3000 psi)	IAP20-..0E	D0175UK
D0186VM	IGP20-..0F	35 MPa (5000 psi)	N/A	N/A

Cobalt-Nickel-Chromium Sensor, Inert Oil Fill Fluid

Part No. (IGP20)	Reference Model Code (IGP20)	Maximum Span	Reference Model Code (IAP20)	Part No. (IAP20)
D0175DT	IGP20-..1A	7.5 kPa (30 inH ₂ O)	N/A	N/A
D0170HG	IGP20-..1B	50 kPa (200 inH ₂ O)	IAP20-..1B	D0175VA
D0170HM	IGP20-..1C	210 kPa (840 inH ₂ O)	IAP20-..1C	D0175VD
D0170HS	IGP20-..1D	2.1 MPa (300 psi)	IAP20-..1D	D0175VG
D0170HX	IGP20-..1E	21 MPa (3000 psi)	IAP20-..1E	D0175VK
D0186VT	IGP20-..1F	35 MPa (5000 psi)	N/A	N/A

316L Stainless Steel Sensor, Silicone Oil Fill Fluid

Part No. (IGP20)	Reference Model Code (IGP20)	Maximum Span	Reference Model Code (IAP20)	Part No. (IAP20)
D0175DN	IGP20-..2A	7.5 kPa (30 inH ₂ O)	N/A	N/A
D0170GG	IGP20-..2B	50 kPa (200 inH ₂ O)	IAP20-..2B	D0175UB
D0170GM	IGP20-..2C	210 kPa (840 inH ₂ O)	IAP20-..2C	D0175UE
D0170GS	IGP20-..2D	2.1 MPa (300 psi)	IAP20-..2D	D0175UH
D0170GX	IGP20-..2E	21 MPa (3000 psi)	IAP20-..2E	D0175UL
D0186VN	IGP20-..2F	35 MPa (5000 psi)	N/A	N/A

316L ss/Gold-Plated Sensor, Silicone Oil Fill Fluid

Part No. (IGP20)	Reference Model Code (IGP20)	Maximum Span	Reference Model Code (IAP20)	Part No. (IAP20)
D0175DS	IGP20-.2GA	7.5 kPa (30 inH ₂ O)	N/A	N/A
D1075CS	IGP20-.2GB	50 kPa (200 inH ₂ O)	IAP20-..2GB	D0175UP
D0175CT	IGP20-.2GC	210 kPa (840 inH ₂ O)	IAP20-..2GC	D0175UR
D0175CU	IGP20-.2GD	2.1 MPa (300 psi)	IAP20-..2GD	D0175UT
D0175CV	IGP20-.2GE	21 MPa (3000 psi)	IAP20-..2GE	D0175UV
D0186VS	IGP20-.2GF	35 MPa (5000 psi)	N/A	N/A

316L Stainless Steel Sensor, Inert Oil Fill Fluid

Part No. (IGP20)	Reference Model Code (IGP20)	Maximum Span	Reference Model Code (IAP20)	Part No. (IAP20)
D0175DU	IGP20-..3A	7.5 kPa (30 inH ₂ O)	N/A	N/A
D0170HH	IGP20-..3B	50 kPa (200 inH ₂ O)	IAP20-..3B	D0175VB
D0170HN	IGP20-..3C	210 kPa (840 inH ₂ O)	IAP20-..3C	D0175VE
D0170HT	IGP20-..3D	2.1 MPa (300 psi)	IAP20-..3D	D0175VH
D0170HY	IGP20-..3E	21 MPa (3000 psi)	IAP20-..3E	D0175VL
D0186VU	IGP20-..3F	35 MPa (5000 psi)	N/A	N/A

Monel Sensor, Silicone Oil Fill Fluid

Part No. (IGP20)	Reference Model Code (IGP20)	Maximum Span	Reference Model Code (IAP20)	Part No. (IAP20)
D0175DP	IGP20-..4A	7.5 kPa (30 inH ₂ O)	N/A	N/A
D0175CA	IGP20-..4B	50 kPa (200 inH ₂ O)	IAP20-..4B	D0175UN
D0175CB	IGP20-..4C	210 kPa (840 inH ₂ O)	IAP20-..4C	D0175UQ
D0175CC	IGP20-..4D	2.1 MPa (300 psi)	IAP20-..4D	D0175US
D0175CD	IGP20-..4E	21 MPa (3000 psi)	IAP20-..4E	D0175UU
D0186VP	IGP20-..4F	35 MPa (5000 psi)	N/A	N/A

Monel Sensor, Inert Oil Fill Fluid

Part No. (IGP20)	Reference Model Code (IGP20)	Maximum Span	Reference Model Code (IAP20)	Part No. (IAP20)
D0175DV	IGP20-..5A	7.5 kPa (30 inH ₂ O)	N/A	N/A
D0175CE	IGP20-..5B	50 kPa (200 inH ₂ O)	IAP20-..5B	D0175VN
D0175CF	IGP20-..5C	210 kPa (840 inH ₂ O)	IAP20-..5C	D0175VQ
D0175CG	IGP20-..5D	2.1 MPa (300 psi)	IAP20-..5D	D0175VS
D0175CH	IGP20-..5E	21 MPa (3000 psi)	IAP20-..5E	D0175VU
D0186VV	IGP20-..5F	35 MPa (5000 psi)	N/A	N/A

Nickel Alloy (a) Sensor, Silicone Oil Fill Fluid

Part No. (IGP20)	Reference Model Code (IGP20)	Maximum Span	Reference Model Code (IAP20)	Part No. (IAP20)
D0175DQ	IGP20-..6A	7.5 kPa (30 inH ₂ O)	N/A	N/A
D0170GJ	IGP20-..6B	50 kPa (200 inH ₂ O)	IAP20-..6B	D0175UC
D0170GP	IGP20-..6C	210 kPa (840 inH ₂ O)	IAP20-..6C	D0175UF
D0170GU	IGP20-..6D	2.1 MPa (300 psi)	IAP20-..6D	D0175UJ
D0170GZ	IGP20-..6E	21 MPa (3000 psi)	IAP20-..6E	D0175UM
D0186VQ	IGP20-..6F	35 MPa (5000 psi)	N/A	N/A

a. Equivalent to Hastelloy C.

Nickel Alloy (a) Sensor, Inert Oil Fill Fluid

Part No. (IGP20)	Reference Model Code (IGP20)	Maximum Span	Reference Model Code (IAP20)	Part No. (IAP20)
D0175DW	IGP20-..7A	7.5 kPa (30 inH ₂ O)	N/A	N/A
D0170HK	IGP20-..7B	50 kPa (200 inH ₂ O)	IAP20-..7B	D0175VC
D0170HQ	IGP20-..7C	210 kPa (840 inH ₂ O)	IAP20-..7C	D0175VF
D0170HV	IGP20-..7D	2.1 MPa (300 psi)	IAP20-..7D	D0175VJ
D0170JA	IGP20-..7E	21 MPa (3000 psi)	IAP20-..7E	D0175VM
D0186VW	IGP20-..7F	35 MPa (5000 psi)	N/A	N/A

a. Equivalent to Hastelloy C.

Tantalum Sensor, Silicone Oil Fill Fluid

Part No. (IGP20)	Reference Model Code (IGP20)	Maximum Span	Reference Model Code (IAP20)	Part No. (IAP20)
D0175DR	IGP20-..8A	7.5 kPa (30 inH ₂ O)	N/A	N/A
D0175CJ	IGP20-..8B	50 kPa (200 inH ₂ O)	IAP20-..8B	D0175UW
D0175CK	IGP20-..8C	210 kPa (840 inH ₂ O)	IAP20-..8C	D0175UX
D0175CL	IGP20-..8D	2.1 MPa (300 psi)	IAP20-..8D	D0175UY
D0175CM	IGP20-..8E	21 MPa (3000 psi)	IAP20-..8E	D0175UZ
D0186VR	IGP20-..8F	35 MPa (5000 psi)	N/A	N/A

Tantalum Sensor, Inert Oil Fill Fluid

Part No. (IGP20)	Reference Model Code (IGP20)	Maximum Span	Reference Model Code (IAP20)	Part No. (IAP20)
D0175DX	IGP20-..9A	7.5 kPa (30 inH ₂ O)	N/A	N/A
D0175CN	IGP20-..9B	50 kPa (200 inH ₂ O)	IAP20-..9B	D0175VW
D0175CP	IGP20-..9C	210 kPa (840 inH ₂ O)	IAP20-..9C	D0175VX
D0175CQ	IGP20-..9D	2.1 MPa (300 psi)	IAP20-..9D	D0175VY
D0175CR	IGP20-..9E	21 MPa (3000 psi)	IAP20-..9E	D0175VZ
D0186VX	IGP20-..9F	35 MPa (5000 psi)	N/A	N/A

Figure 3. TRANSMITTER ASSEMBLY – BOTTOMWORKS

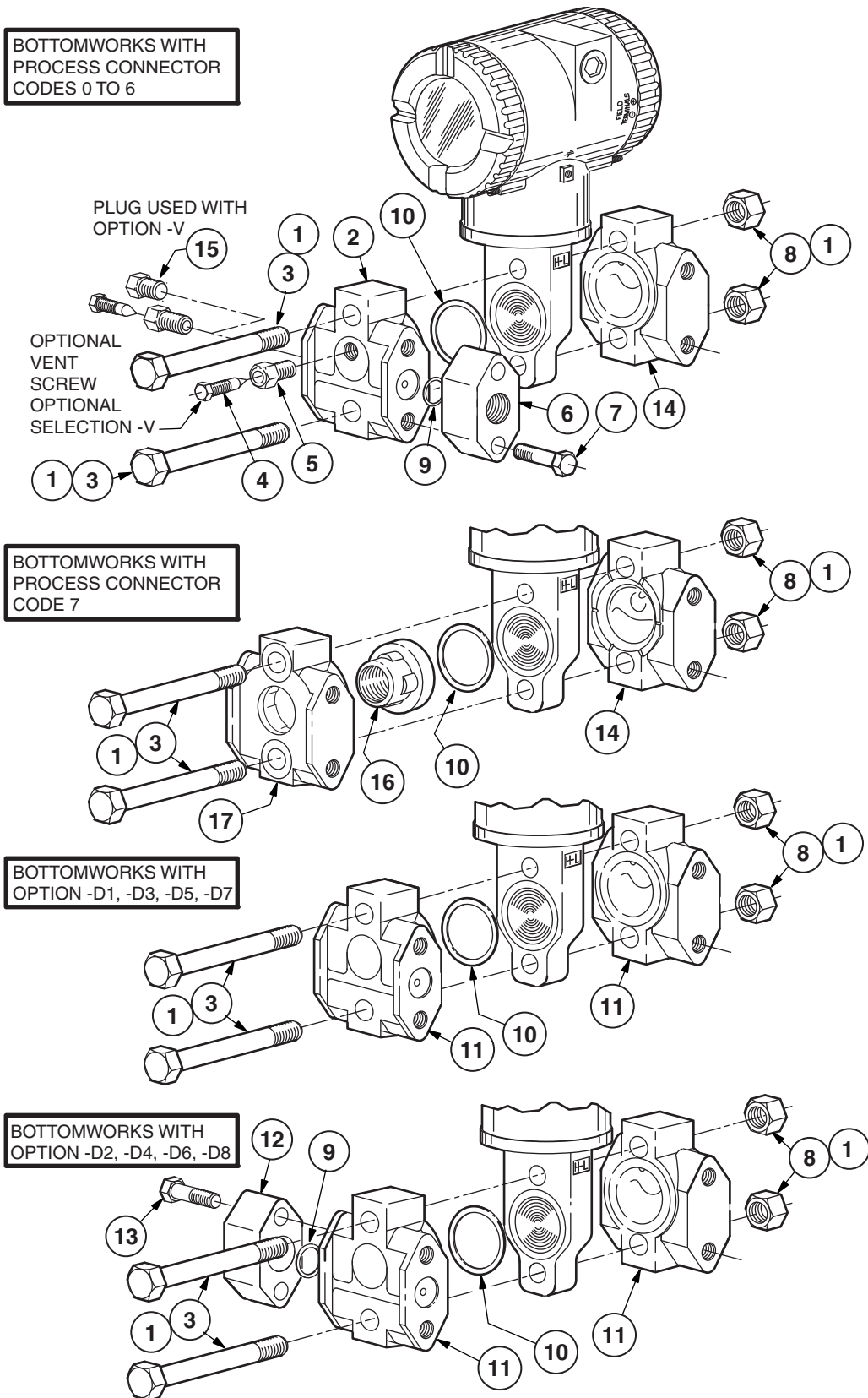

Item	Part No.	Qty.	Part Name
1	X0118CC	1	Grease, Lubriplate (1-3/4 ounce tube)
2	Below	1	Process Cover, High Side (Process Conn. Codes 0-6) (see Note 1)
	D0161NA		316 ss
	D0161NB		Carbon Steel
	D0161NC		Nickel alloy (a)
	D0161ND		Monel
2	Below	1	Process Cover, Side Vent (Process Conn. Codes 0-6) (Note 1)
	D0161NE		316 ss
	D0161NF		Carbon Steel
	D0161NG		Nickel alloy (a)
	D0161NH		Monel
3	Below	2	Screw, hex head, 0.500-13 x 3.5
	X0173RP		2H (ASTM A193, Gr. B7 [std])
	X0173TQ		316 ss (ASTM F593, Group 2) (Options -B1, -D5, -D6)
	X0173UK		ASTM A193, Gr. B7M (Option -B3)
	X0173TD		17-4 ss (ASTM A564, Type 630) (Options -B2, -D7, -D8)
*4	Below	2	Vent Screw
	B0138MJ		316 ss (std)
	B0138MK		Monel
	D0175PQ		Nickel alloy (a) (Note 1)
*5	Below	1	Vent Plug (see Note 2)
	D0161QT		316 ss (std)
	D0161QU		Monel (see Note 1)
	D0175PP		Nickel alloy (a) (Note 1)
6	Table 1	1	Process Connectors (see Table 1)

a. Equivalent to Hastelloy C.

Table 1. Item 6, Process Connectors

Process Conn. Code	Connector Description	Used with Following Cover Material			
		Carbon Steel	Stainless Steel	Nickel Alloy (a)	Monel
1	1/4 NPT	N0141XF	N0141XT	–	N0141XK
2	1/2 NPT	N0141XM	N0141XN	B0139JW	N0141XL
3	Rc 1/4	B0139BB	B0139BD	–	B0139BC
4	Rc 1/2	B0139BE	B0139BG	B0139JV	B0139BF
6	1/2 Schedule 80 Weld Neck	N0141XP	N0141XR	–	D0143CZ

a. Equivalent to Hastelloy C.

— NOTE —

1. Metallic process wetted material conforming to NACE Standard MR-01-75.
2. For simplified calibration, install F0101ES screw for pressure up to 0.7 MPa (100 psi).

PARTS

Item	Part No.	Qty.	Part Name
7	Below	2	Screw, hex head, 0.438-20 x 1.5 (for threaded connectors, Codes 1-4)
	X0100MN		ASTM A193 Gr. B7 (std)
	X0171VP		ASTM A193, Gr. B7M (Option -B3)
	X0118AX		17-4 Stainless Steel (Options -B2, -D7, -D8)
	N1205RQ		316 ss (Options -B1, -D5, -D6)
7	Below	2	Screw, hex head, 0.438-20 x 1.0 (for weld neck connectors, Code 6)
	X0100NT		ASTM A193, Gr. B7 (std)
	X0171VN		ASTM A193, Gr. B7M (Option -B3)
	X0118AY		17-4 Stainless Steel (Option -B2)
	X0173TP		316 ss (Option -B1)
8	Below	2	Nut, hex head, 0.500-13
	X0173RN		2H (ASTM A193, Gr. B7 [std])
	X0173UL		ASTM A194, Gr. 2HM (Option -B3)
	X0173UJ		17-4 ss (ASTM F594, Group 2) (Options -B2, -D7, -D8)
	X0173TR		316 ss (ASTM F594, Group 2) (Options -B1, -D5, -D6)
*9	D0114RB	1	Gasket, ptfе
*10	Below	1	Gasket
	D0161QQ		Glass-filled ptfе (standard)
	X0145MJ		Viton (used with Process Connector Code 7)
11	Below	1	Cover, 316 ss - for use with Options -D1, -D3, -D5, -D7
	D0161NK		High Side, Single Ended Process Connection M10, ss (Option -D1)
	D0161NM		High Side, Single Ended Process Connection 7/16, ss (Options -D3, -D5, -D7)
11	Below	1	Cover, 316 ss - for use with Options -D2, -D4, -D6, and -D8
	D0161NN		Double Ended Process Connection M10, ss (Option -D2)
	D0161NA		Double Ended Process Connection 7/16, ss (Options -D4, -D6, -D8)
12	D0153RK		Kidney Flange, Blind, 316 ss - for use with Options -D2, -D4, -D6, and -D8 (for double-ended process cover)
13	Below	4	Screw, Hex Head, steel, for blind kidney flange - for Options -D2, -D4, -D6, -D8
	X0173MJ		M10 x 1.5 x 40 mm, for Option -D2
	X0100MN		0.437-20 x 1.5 in, for Options -D4, -D6, and -D8
14	Below	1	Cover, Low Side - for Process Connector Codes 0-7
	D0161NR		M10, ss
	D0161NP		7/16, ss
15	Below	1	Pipe Plug
	D0161LU		316 ss
	D0161LV		Monel
	D0161LW		Nickel alloy (a)
16	D0175TA	1	Insert, pvdf (used with Process Connector Code 7)
17	D0175TB	1	Cover, High Side (used with Process Connector Code 7)
			(Item 16 pvdf Insert fits into cover)

a. Equivalent to Hastelloy C.

Figure 4. PRESSURE SEALS FOR USE WITH IAP20 AND IGP20 TRANSMITTERS

— NOTE —

The pressure seals shown in Figure 4 are used with the IAP20 and IGP20 Absolute and Gauge Pressure Transmitters. They, and also the sensor assemblies, are not replaceable items but must be replaced with the entire transmitter/seal assembly. In this case, both transmitter and pressure seal Model Numbers must be used for the assembled transmitter/seal system. Refer to data plates attached to transmitter and pressure seal for applicable part numbers, or refer to PSS 2A-1Z11A for Pressure Seal Model Codes.

MODEL PSFLT
FLUSH DIAPHRAGM
FLANGED LEVEL SEAL

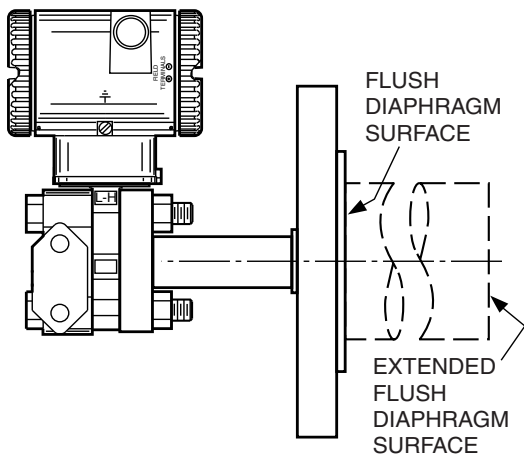

MODEL PSFPS AND PSFES
FLUSH DIAPHRAGM-FLANGED CONNECTION
REMOTE MOUNT SEALS

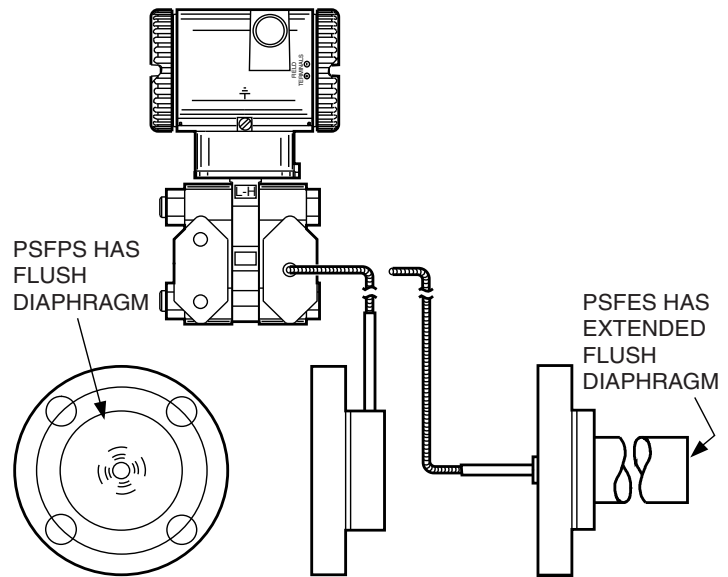

MODEL PSSST
FLUSH DIAPHRAGM
SANITARY TANK SPUD SEAL

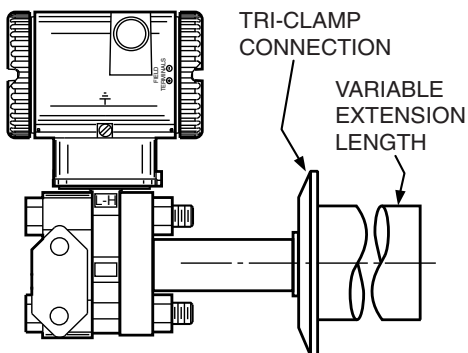

MODEL PSSCT
FLUSH DIAPHRAGM
SANITARY SEAL WITH TRI-CLAMP

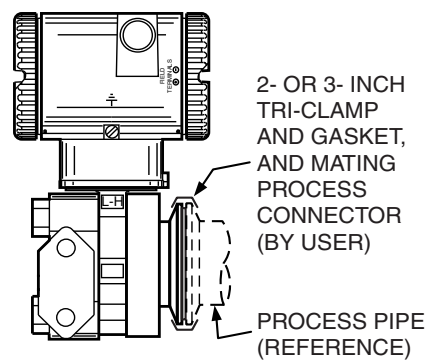

Tri-Clamp Provided by the Company (a)

Description	Part Number
4-in Standard Spud	N1212AW
2-in Mini-Spud	N1212HG

a. Gasket provided by user.

FIGURE 4. PRESSURE SEALS FOR USE WITH IAP20 AND IGP20 TRANSMITTERS (Contd.)

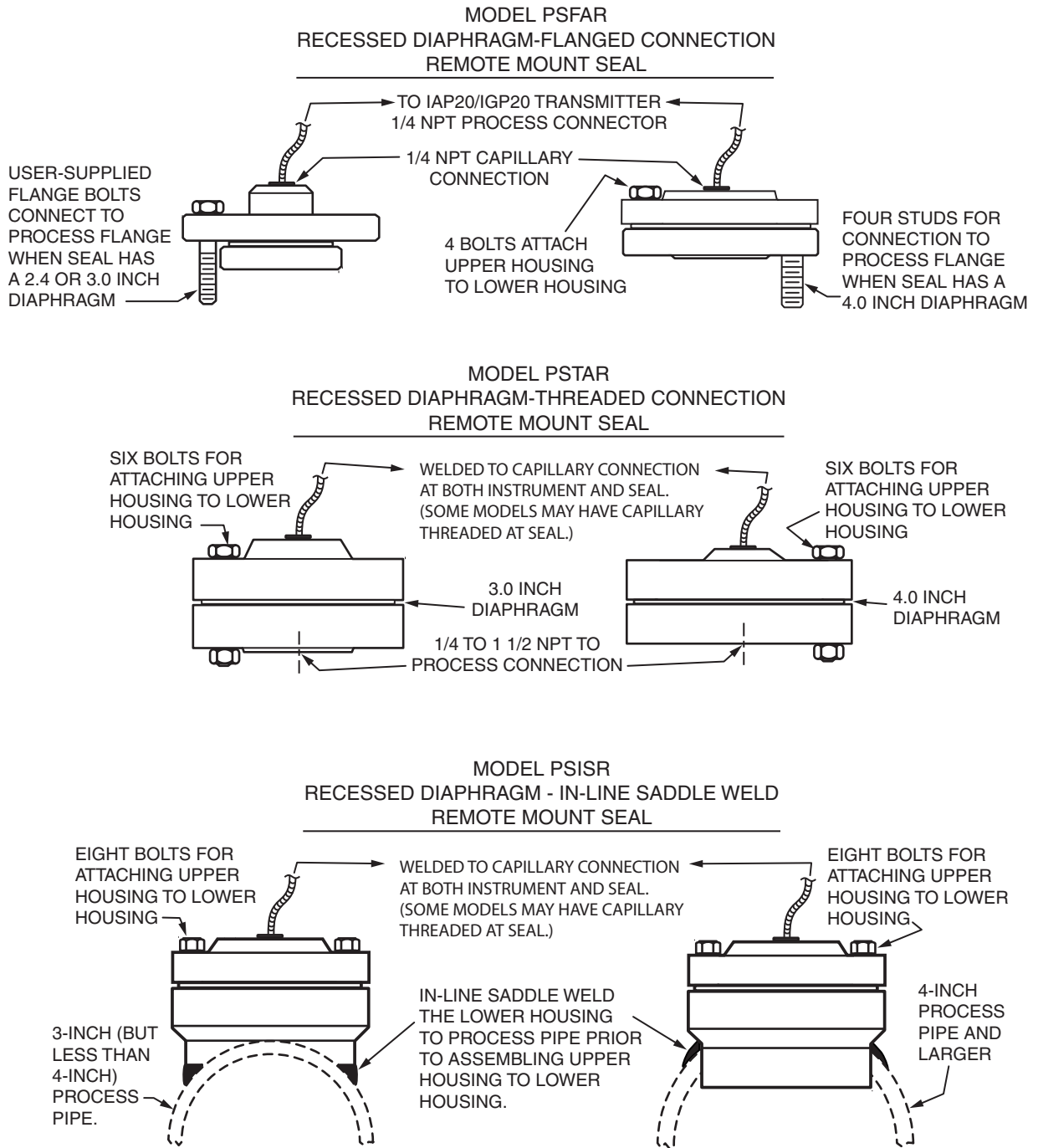
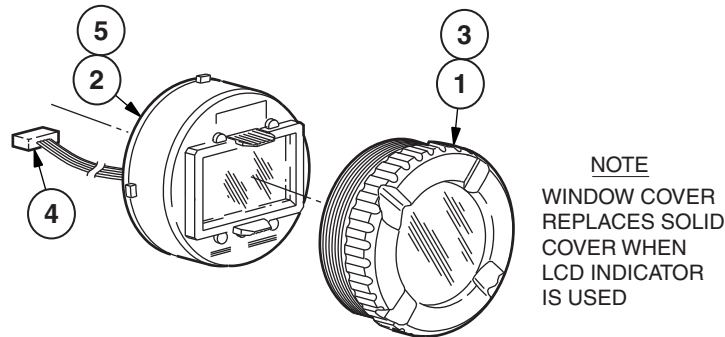
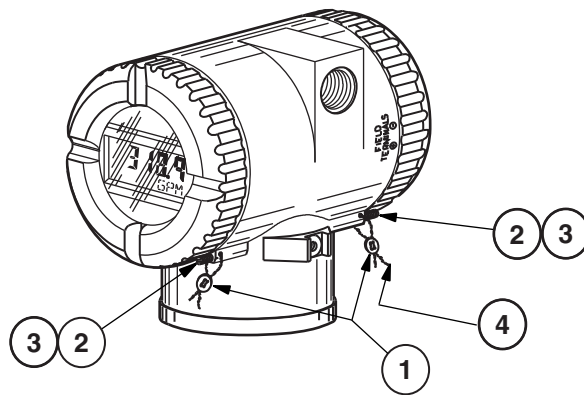

Figure 5. OPTIONAL LIQUID CRYSTAL DISPLAY (LCD) INDICATOR ASSEMBLY
Optional Selection -L1 (For Electronics Version Codes -D, -F, and -T only)



Item	Part No.	Qty.	Part Name
1	Below	1	Cover Assembly with Window - used with LCD Indicator
	D0162LH		Aluminum Cover Assembly
	D0162VH		Stainless Steel Cover Assembly
*2	D0162LQ	1	Indicator Module
3	X0118CC	A/R	Grease, Lubriplate (1-3/4 ounce tube)
4	P0177HB	1	Indicator Cable
5	0048130	A/R	Grease, Silicone (150 gram tube)

Figure 6. OPTIONAL CUSTODY TRANSFER LOCK AND SEAL
Optional Selection -Z2



Item	Part No.	Qty.	Part Name
1	S001806	2	Lead Seal
2	D0162WM	2	Screw, Lock, 0.164-32
3	X0118CC	A/R	Grease, Lubriplate (1-3/4 ounce tube)
4	S001807	A/R	Sealing Wire

Figure 7. OPTIONAL PIPE MOUNTING SETS
Optional Selection -M1 or -M2 (Standard Style Bracket) (See next page for Optional Selection -M3)

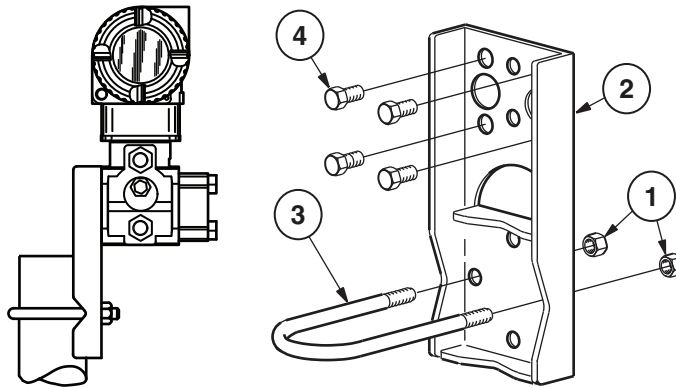

NOTES

1. ALSO SEE FIG. 11 IF REPLACING AN 823DP, 843DP, OR 863DP TRANSMITTER WITH AN IGP20 TRANSMITTER.
2. STANDOFFS SHOWN IN FIG. 11 MAY ALSO BE USED IN WALL MOUNT INSTALLATIONS TO PROVIDE EASIER ACCESS TO VENT AND DRAIN SCREWS.

Optional Selection -M1 (Painted Steel)

Item	Part No.	Qty.	Part Name
–	N0141ZT	–	Mounting Set, steel (Items 1, 2, 3, and 4)
1	0011962	2	Nut, plated steel, 0.312-18
2	N0141ZW	1	Bracket, Mounting; painted steel
3	D0114SM	1	U-Bolt, steel
4	X0100NW	4	Screw, hex head, plated steel, 0.437-20 x 0.625

Optional Selection -M2 (Stainless Steel)

Item	Part No.	Qty.	Part Name
–	N1205YD	–	Mounting Set, ss (Items 1, 2, 3, and 4)
1	Z1217HV	2	Nut, hex head, ss, 0.312-18
2	N1205MF	1	Bracket, Mounting; ss
3	N1205MX	1	U-Bolt, ss
4	P0120RN	4	Screw, hex head, ss, 0.437-20 x 0.625

Figure 8. OPTIONAL PIPE MOUNTING SET

Optional Selection -M3 (Universal Style Bracket) (See previous page for Optional Selections -M1 or -M2)

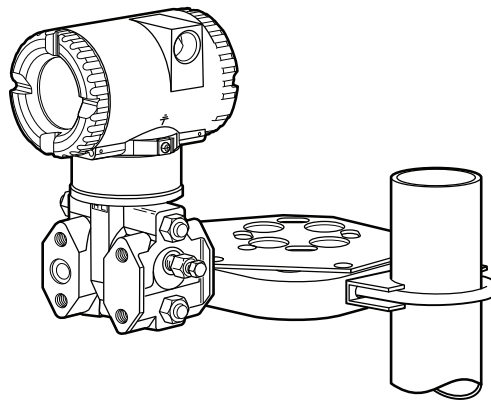
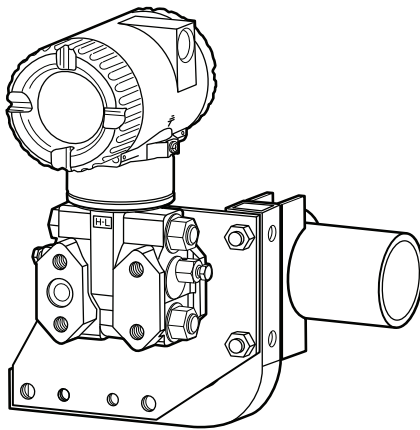
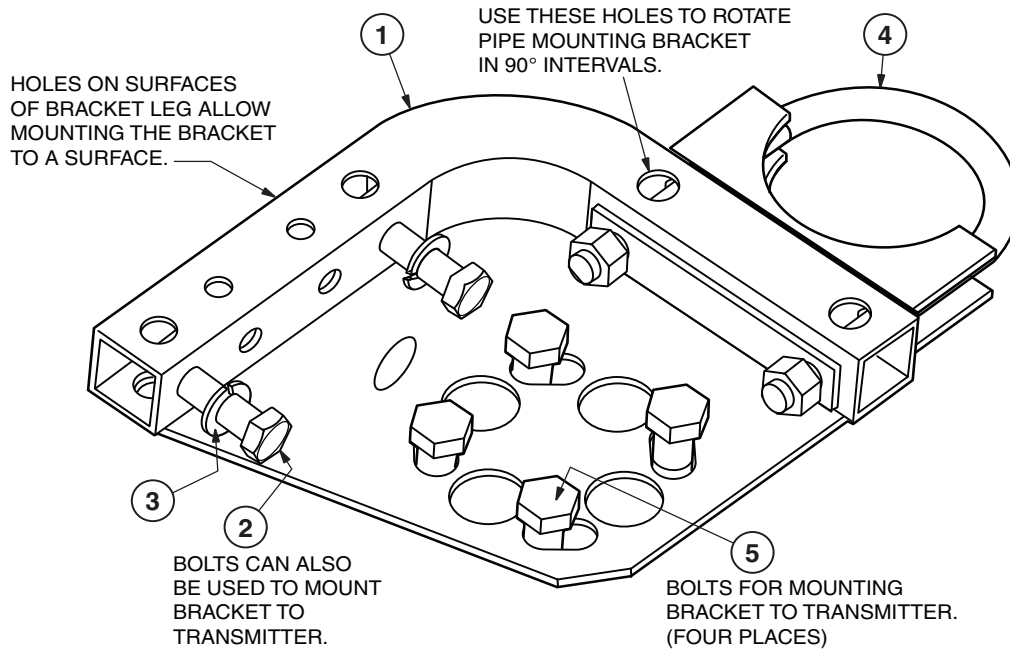

Item	Part No.	Qty.	Part Name
-	D0170XH	1	Universal Pipe Mounting Set (Items 1 to 4)
1	D0170VJ	1	Bracket, Universal Mounting, ss
2	X0173UR	2	Screw, hex head; ss; 0.375-16 x 1.5
3	A2012TZ	2	Washer, lock; 0.382 I.D.; ss
4	D0170VM	1	U-Bolt Kit:
			U-Bolt; ss; 0.312-18
			Clamp, saddle; ss
			Plate, washer; ss
			Nut, hex head; ss; 0.312-18
5	P0120RN	4	Screw, hex head; 0.437-20 x 0.625; ss

Figure 9. OPTIONAL CONDUIT CONNECTORS
Optional Selection -A1, -A2, or -A3

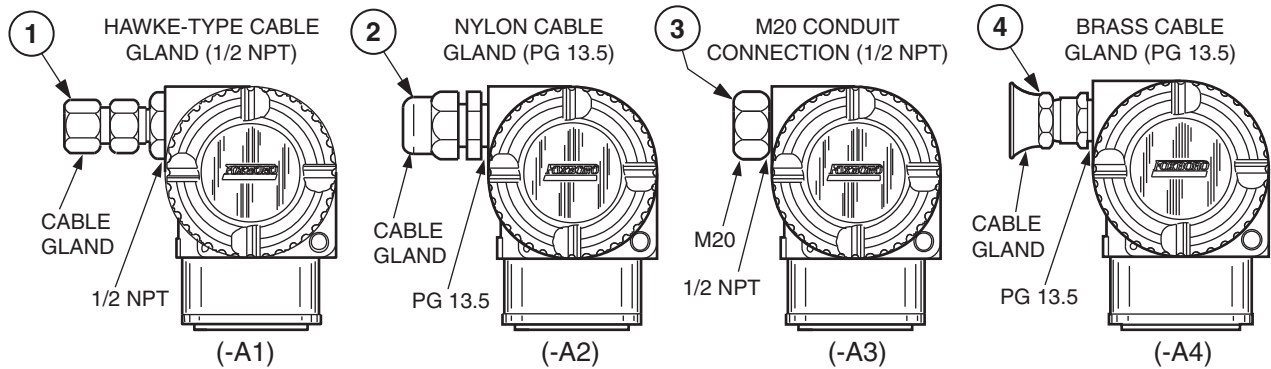

Item	Part No.	Qty.	Part Name
1	N7141HX	1	Hawke-Type Cable Gland Connection
2	X0178GU	1	Nylon Cable Gland (for PG 13.5)
3	N7141DX	1	Metric Conduit Thread Connection, M20/20 mm (for 1/2 NPT)
4	N7141DW	1	Plated Brass Cable Gland (for PG 13.5)

Figure 10. OPTIONAL TUBING CONNECTOR
Optional Selection -E1, -E2, -E3, or -E4

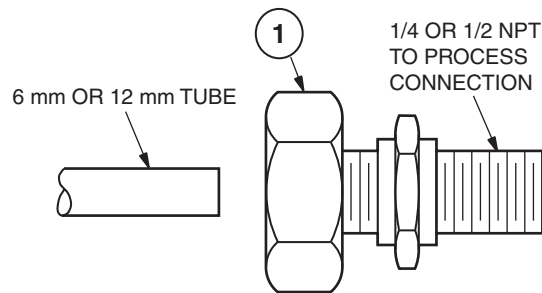

Item	Part No.	Qty.	Part Name
1	Below	-	Process Connector,
	U7002AT		Carbon Steel, 640 bar (1/4 NPT x 6 mm), Optional Selection -E1
	U7002AR		Carbon Steel, 640 bar (1/2 NPT x 12 mm), Optional Selection -E2
	U7002AS		316 ss, 640 bar (1/4 NPT x 6 mm), Optional Selection -E3
	U7002AP		316 ss, 640 bar (1/2 NPT x 12 mm), Optional Selection -E4

Figure 11. REPLACING MODELS 823DP, 843DP, AND 863DP WITH AN IGP20 TRANSMITTER

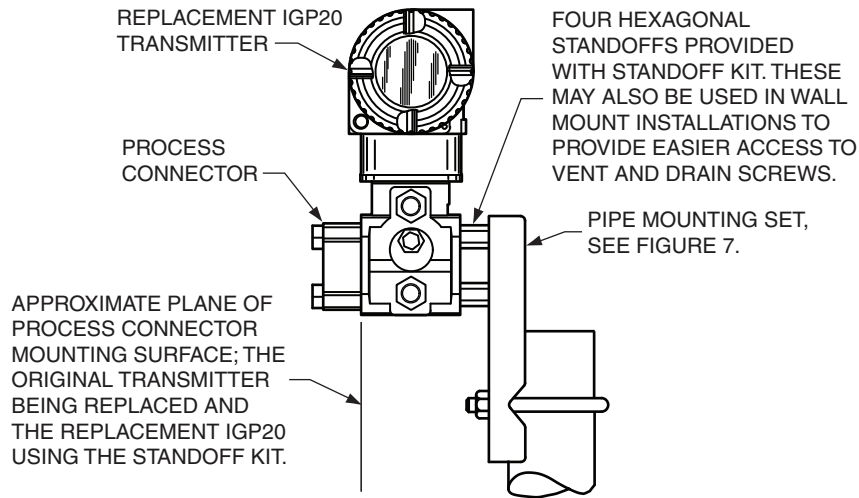

Description of Transmitter being Replaced	Kit Part Number for (a)	
	Steel	Stainless Steel
823DP with 20 MPa (3000 psi, 200 bar or kg/cm ²) Static Pressure Rating	D0170MB	D0170MF
823DP with 40 MPa (6000 psi, 400 bar or kg/cm ²) Static Pressure Rating	D0170MC	D0170MG
843DP or 863DP with Single Ended Cover	D0170MD	D0170MH
843DP or 863DP with Double Ended Cover	D0170ME	D0170MJ

a. The kit consists of four standoffs. Select steel if mounting screws in Figure 7 are steel, and select stainless steel if mounting screws in Figure 7 are stainless steel.

Figure 12. OPTIONAL SIL2 TRANSMITTER FOR HART VERSIONS
Optional Selection -S2

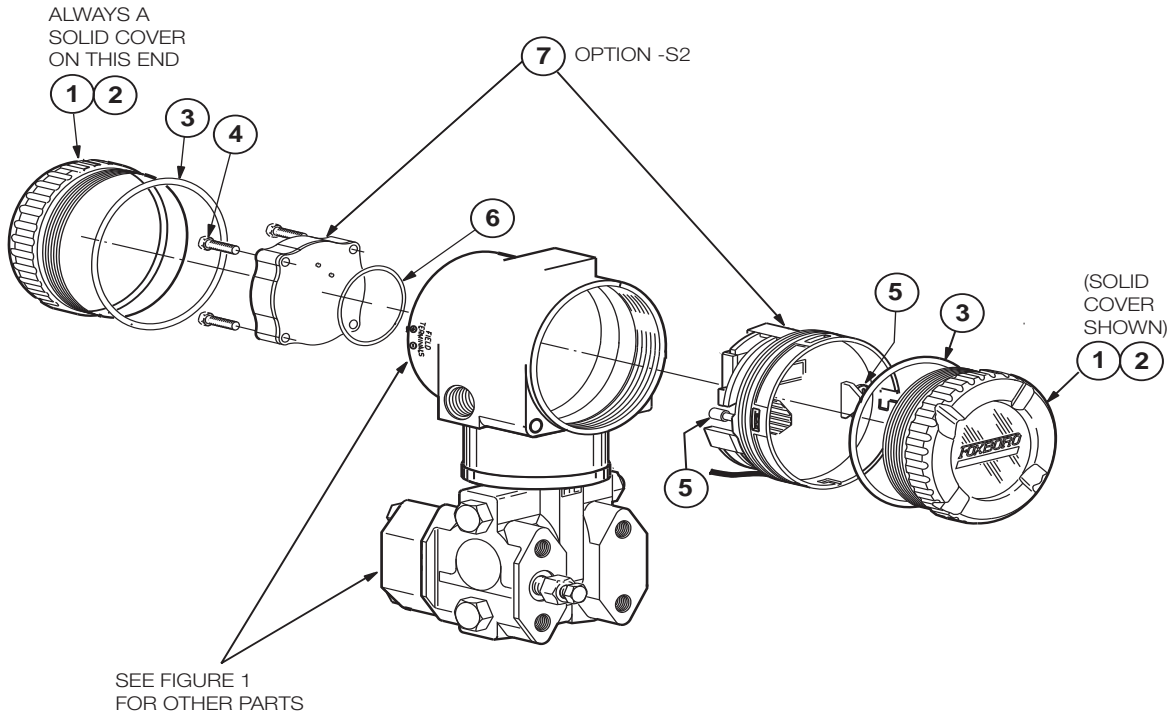

Item	Part No.	Qty.	Part Name
1	Below	2	Cover, Electronics Housing (Note 1)
	B0162AP		Solid Cover, Aluminum
	B0162VD		Solid Cover, Stainless Steel
2	X0118CC	1	Grease, Lubriplate; 1 3/4 ounce Tube
3	X0201FC	2	O-Ring, Cover
4	Below	4	Screw, Terminal Block Assy; 0.138-32 x 0.750
	X0133UW		Steel Screw used with Aluminum Housing
	X0133VP		316 ss Screw used with 316 ss Housing
5	Below	2	Screw, Captive, Panhd; 0.118-32 x 0.615
	D0162VM		Steel Screw used with Aluminum Housing
	D0166CY		316 ss Screw used with 316 ss Housing
6	X0144KR	1	O-Ring, Terminal Block
7	D0197FP	1	SIL2 Kit for SIL2-Certified HART Versions only (Note 2)

— NOTE —

1. A solid cover on the electronics end of the housing is shown. When the LCD Indicator Option (Option -L1) is selected, a window cover is provided as shown in Figure 5.
2. SIL2 Transmitters are available with HART versions. A SIL2 Kit comprises a terminal block assembly, a characterized HART electronics module (with label), and instructions. Replacement of SIL2 Option -S2 must be performed using the SIL2 kit.

RECOMMENDED SPARE PARTS SUMMARY

Figure Number	Item Number	Part Number	Part Name	Number of Parts Recommended for		
				1 Inst.	5 Inst.	20 Inst.
1	3	X0201FC	O-Ring, Cover	0	2	4
	10	Below D0162VR D0162JU D0162VZ D0162ZP D0162ZX	Electronics Module Digital FoxCom and/or 4 to 20 mA (Version -D) Digital FOUNDATION Fieldbus (Version -F) Digital HART and 4 to 20 mA (Version -T) Analog 4 to 20 mA (Version -A) Analog 1 to 5 V dc, Low Power (Version -V)	0	1	1
	12 (Also see Figure 2)	Below D0175DM D0170GF D0170GL D0170GR D0170GW D0186VM D0175DT D0170HG D0170HM D0170HS D0170HX D0186VT D0175DN D0170GG D0170GM D0170GS D0170GX D0186VN D0175DS D0175CS D0175CT D0175CU D0175CV D0186VS D0175DU D0170HH D0170HN D0170HT D0170HY D0186VU D0175DP D0175CA D0175CB D0175CC D0175CD D0186VP D0175DV D0175CE D0175CF D0175CG D0175CH D0186VV	IGP20 Sensor Assembly (Ref. Model Code) (a) IGP20-..0A IGP20-..0B IGP20-..0C IGP20-..0D IGP20-..0E IGP20-..0F IGP20-..1A IGP20-..1B IGP20-..1C IGP20-..1D IGP20-..1E IGP20-..1F IGP20-..2A IGP20-..2B IGP20-..2C IGP20-..2D IGP20-..2E IGP20-..2F IGP20-..2GA IGP20-..2GB IGP20-..2GC IGP20-..2GD IGP20-..2GE IGP20-..2GF IGP20-..3A IGP20-..3B IGP20-..3C IGP20-..3D IGP20-..3E IGP20-..3F IGP20-..4A IGP20-..4B IGP20-..4C IGP20-..4D IGP20-..4E IGP20-..4F IGP20-..5A IGP20-..5B IGP20-..5C IGP20-..5D IGP20-..5E IGP20-..5F	0	1	1

a. Also see Figure 2 and associated tables for material specifications and maximum spans for the sensor assemblies.

RECOMMENDED SPARE PARTS SUMMARY (Cont.)

Figure Number	Item Number	Part Number	Part Name	Number of Parts Recommended for		
				1 Inst.	5 Inst.	20 Inst.
1 (Cont.)	12 (Also see Figure 2)	Below	IGP20 Sensor Assy (Ref. Model Code Cont.) (a)	0	1	1
		D0175DQ	IGP20-..6A			
		D0170GJ	IGP20-..6B			
		D0170GP	IGP20-..6C			
		D0170GU	IGP20-..6D			
		D0170GZ	IGP20-..6E			
		D0186VQ	IGP20-..6F			
		D0175DW	IGP20-..7A			
		D0170HK	IGP20-..7B			
		D0170HQ	IGP20-..7C			
		D0170HV	IGP20-..7D			
		D0170JA	IGP20-..7E			
		D0186VW	IGP20-..7F			
		D0175DR	IGP20-..8A			
		D0175CJ	IGP20-..8B			
		D0175CK	IGP20-..8C			
		D0175CL	IGP20-..8D			
		D0175CM	IGP20-..8E			
		D0186VR	IGP20-..8F			
		D0175DX	IGP20-..9A			
		D0175CN	IGP20-..9B			
		D0175CP	IGP20-..9C			
		D0175CQ	IGP20-..9D			
		D0175CR	IGP20-..9E			
		D0186VX	IGP20-..9F			
		Below	IAP20 Sensor Assembly (Ref. Model Code) (a)	0	1	1
		D0175UA	IAP20-..0B			
		D0175UD	IAP20-..0C			
		D0175UG	IAP20-..0D			
		D0175UK	IAP20-..0E			
		D0175VA	IAP20-..1B			
		D0175VD	IAP20-..1C			
		D0175VG	IAP20-..1D			
		D0175VK	IAP20-..1E			
		D0175UB	IAP20-..2B			
		D0175UE	IAP20-..2C			
		D0175UH	IAP20-..2D			
		D0175UL	IAP20-..2E			
		D0175UP	IAP20-.2GB			
		D0175UR	IAP20-.2GC			
		D0175UT	IAP20-.2GD			
		D0175UV	IAP20-.2GE			
		D0175VB	IAP20-..3B			
		D0175VE	IAP20-..3C			
		D0175VH	IAP20-..3D			
		D0175VL	IAP20-..3E			
		D0175UN	IAP20-..4B			
		D0175UQ	IAP20-..4C			
		D0175US	IAP20-..4D			
		D0175UU	IAP20-..4E			
		D0175VN	IAP20-..5B			

RECOMMENDED SPARE PARTS SUMMARY (Cont.)

Figure Number	Item Number	Part Number	Part Name	Number of Parts Recommended for		
				1 Inst.	5 Inst.	20 Inst.
1 (Cont.)	12 (Also see Figure 2)	Below D0175VQ D0175VS D0175VU D0175UC D0175UF D0175UJ D0175UM D0175VC D0175VF D0175VJ D0175VM D0175UW D0175UX D0175UY D0175UZ D0175VW D0175VX D0175VY D0175VZ	IAP20 Sensor Assy (Ref. Model Code Cont.) (a) IAP20-...5C IAP20-...5D IAP20-...5E IAP20-...6B IAP20-...6C IAP20-...6D IAP20-...6E IAP20-...7B IAP20-...7C IAP20-...7D IAP20-...7E IAP20-...8B IAP20-...8C IAP20-...8D IAP20-...8E IAP20-...9B IAP20-...9C IAP20-...9D IAP20-...9E	0	1	1
2	1	Below X0201LY X0144KW	O-Ring, Housing Neck Standard For use with CSA Certifications only.	1	2	4
3	4	Below B0138MJ B0138MK D0175PQ	Vent Screw 316 ss (standard) Monel Nickel alloy (b) (to NACE Standard MR-01-75)	0	2	4
	5	Below D0161QT D0161QU D0175PP	Vent Plug 316 ss (standard) Monel Nickel alloy (b) (to NACE Standard MR-01-75)	0	2	4
	9	D0114RB	Gasket, ptfе	1	2	4
	10	Below D0161QQ X0145MJ	Gasket Glass-filled ptfе (Standard) Viton (used with Process Connector Code 7)	1	2	4
	16	D0175TA	Insert, pvdf (used with Process Connector Code 7)	1	2	4
5	2	D0162LQ	LCD Indicator Module	0	1	1
12	7	D0197FP	SIL2 Kit for SIL-Certified HART Transmitters	0	1	1

a. Also see Figure 2 and associated tables for material specifications and maximum spans for the sensor assemblies.

b. Equivalent to Hastelloy C.